

C-86-16

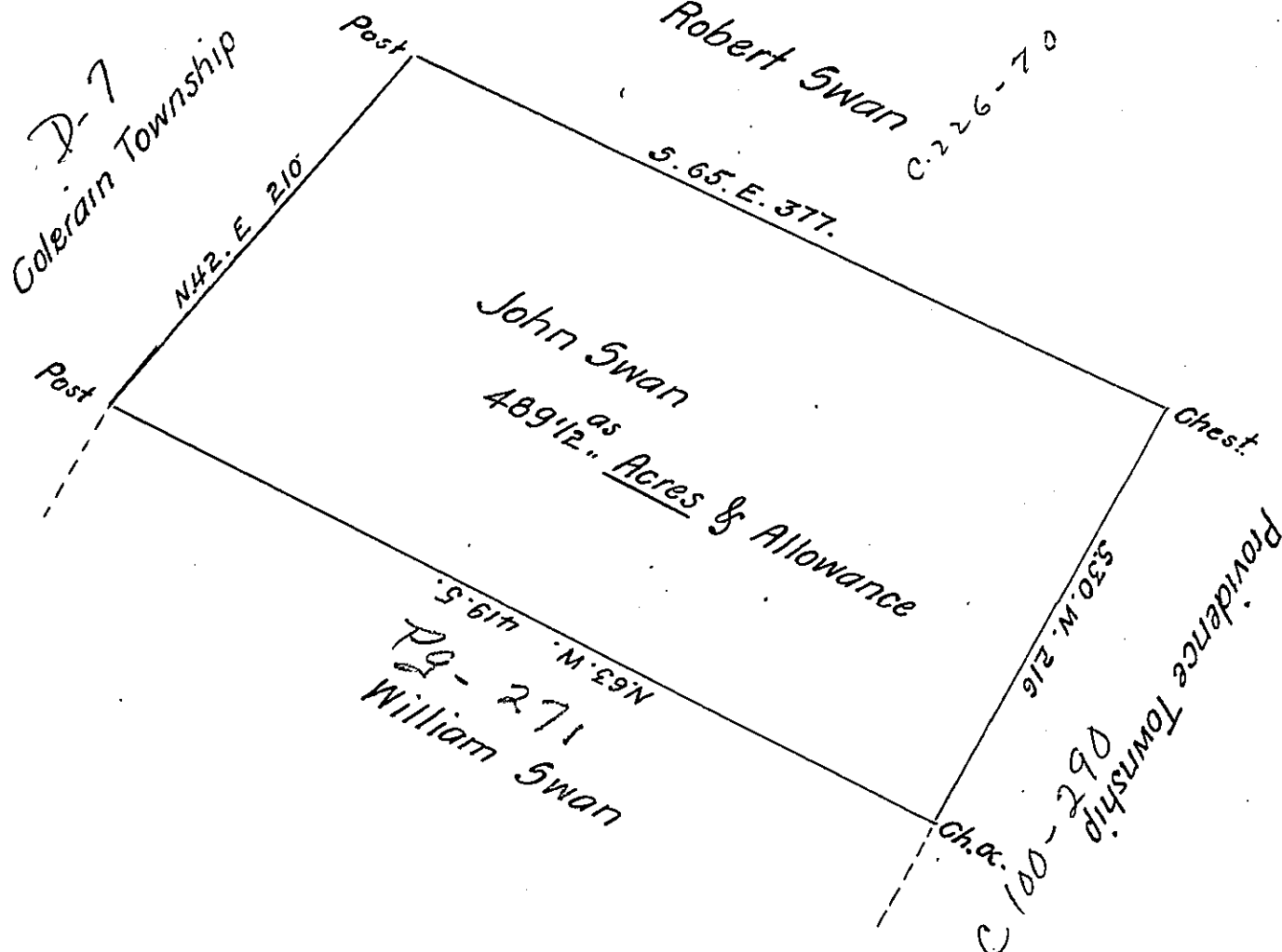

Situate on the Terrass Mountain in Colerain & Providence Townships,
 Bedford County, containing 489 1/2 acres and the usual allowance of six f.
 Ct. for Roads & Surveyed for John Swan the 12th Day of December 1829. On
 Warrant dated the 10th day of April 1794.

To Gabriel Hiester Esq.
 Surveyor General.

James Piper D.S.

IN TESTIMONY that the above is a copy of the original remaining on file in
 the Department of Internal Affairs of Pennsylvania, made
 conformably to an Act of Assembly approved the 16th day of
 February, 1833, I have hereunto set my Hand and caused
 the Seal of said Department to be affixed at Harrisburg,
 this thirty-first day of January 1907

Isaac B. Brown
 Secretary of Internal Affairs.